

Cover Sheet: Request 11180

Joint Certificate Program - CM, ARCH, ENG

Info

Process	Certificate New Ugrad/Pro
Status	Pending
Submitter	Wehle,Andrew J wehleaj@ufl.edu
Created	10/11/2016 11:55:26 AM
Updated	4/11/2017 8:29:55 AM
Description of request	The College of Design, Construction and Planning and the Herbert Wertheim College of Engineering seek to create an undergraduate certificate which would be held jointly by the two colleges. This initiative is expected to usher in a new era of cooperation between Engineering, Architecture and Construction Management and will trigger the exploration of additional opportunities for collaboration at the intersection of these disciplines.

Actions

Step	Status	Group	User	Comment	Updated
Department	Approved	DCP - Design, Construction and Planning 011501000	Chini, Abdol Reza		4/7/2017
Added MOUConstructionManagementCertificateProgram.docx					10/11/2016
College	Approved	DCP - College of Design, Construction and Planning	Chini, Abdol Reza		4/7/2017
No document changes					
Office of Institutional Planning and Research	Approved	PV - Office of Institutional Planning and Research	Zeglen, Marie	CIP 04.0201 is approved for this certificate.	4/11/2017
No document changes					
University Curriculum Committee	Pending	PV - University Curriculum Committee (UCC)			4/11/2017
No document changes					
Office of the Registrar					
No document changes					
OIPR Notified					
No document changes					
Student Academic Support System					
No document changes					
Catalog					
No document changes					

Step	Status	Group	User	Comment	Updated
Academic Assessment Committee Notified					
No document changes					
College Notified					
No document changes					

Certificate|New for request 11180

Info

Request: Joint Certificate Program - CM, ARCH, ENG

Description of request: The College of Design, Construction and Planning and the Herbert Wertheim College of Engineering seek to create an undergraduate certificate which would be held jointly by the two colleges. This initiative is expected to usher in a new era of cooperation between Engineering, Architecture and Construction Management and will trigger the exploration of additional opportunities for collaboration at the intersection of these disciplines.

Submitter: Wehle, Andrew J wehleaj@ufl.edu

Created: 10/11/2016 11:56:29 AM

Form version: 3

Responses

Certificate Name Construction Management, Architecture and Engineering

Transcript Title Construction, Architecture and Engineering

Credits 12

Level Baccalaureate

CIP Code 04.0201

Degree Program Construction Management, Architecture, and Engineering

Effective Term Fall

Effective Year 2017

Certificate Description Students completing the certificate will have an opportunity to learn about the close interrelationships as well as the distinct skills required among practitioners of the built environment. This certificate will distinguish graduates with an exceptional experience as well as demonstrative collaborative skills, providing an advantage in the competitive work environment.

Requirements for Admission Students enrolled in civil engineering, construction management, and architecture programs with an interest in careers in designing and constructing the built environment, especially in effective and collaborative integrated teams of engineers, architects, and constructors.

Requirements for Completion Students will take courses in the School of Architecture, the Rinker School of Construction Management, and the HWCOE Engineering Innovation and Engineering Leadership Institutes. All students will be required to take one 3-credit common course on Integrated Project Delivery co-taught by the three units on the integration and professional practices of the disciplines. In addition, students will take 9 additional credits by selecting one course from the School of Architecture, another offered by Engineering Innovation and Engineering Leadership Institutes, and one last course from the Rinker School of Construction Management. Listed below are candidate course electives under each unit.

From the Rinker School of Construction Management select one course:

- BCN 4753 Construction Finance
- BCN 4723 Design-Build Delivery Methods
- BCN 4252 Introduction to BIM
- BCN 4709 Project management
- BCN 4787 Construction Capstone (IPD has a separate section)
- BCN 3027 Intro to Construction Management (covers basic project management, human factors, introduces estimating and scheduling)
- BCN 3611 Estimating 1
- BCN 4720 Const. Planning and Control (scheduling)

From the HWCOE Engineering Innovation and Engineering Leadership Institutes:

- ESI 4XXX Engineering Project Management
- EGS 4038 Engineering Leadership
- EGN 4641 Engineering Entrepreneurship
- EGN 4643 Engineering Innovation

From the School of Architecture:

- ARC 4684 LEED for Sustainable Architecture
- ARC 4930 Coastal Construction
- ARC 4511 Structural Modeling
- ARC 4930 Advanced Architecture Connections
- ARC 4930 European Sustainability

Rationale and Place in Curriculum The College of Design, Construction and Planning and the Herbert Wertheim College of Engineering seek to create an interdisciplinary undergraduate certificate. This certificate will usher in a new era of cooperation between Engineering, Architecture and Construction Management and will facilitate the exploration of additional opportunities for collaboration at the intersection of these disciplines.

Student Learning Outcomes SLO 1

SLO 2

SLO 3

Memorandum of Understanding

Between

The College of Design, Construction and Planning

And

The Herbert Wertheim College of Engineering (HWCOE)

For the creation of a:

Joint Undergraduate Certificate Program in Construction Management, Architecture and Engineering

The College of Design, Construction and Planning and the Herbert Wertheim College of Engineering seek to create an undergraduate certificate which would be held jointly by the two colleges. This initiative is expected to usher in a new era of cooperation between Engineering, Architecture and Construction Management and will trigger the exploration of additional opportunities for collaboration at the intersection of these disciplines.

Eligible Undergraduate Students. The proposed certificate will be aimed at civil engineering, construction management, and architecture students interested in careers in designing and constructing the built environment, especially in effective and collaborative integrated teams of engineers, architects, and constructors. The certificate would consist of 12 credits (four courses of 3 credits each). Between the two colleges three new Professors of the Practice will be hired to teach and manage this certificate program.

Students will take courses in the School of Architecture, the Rinker School of Construction Management, and the HWCOE Engineering Innovation and Engineering Leadership Institutes. All students will be required to take one 3-credit common course on Integrated Project Delivery co-taught by the three units on the integration and professional practices of the disciplines. In addition, students will take 9 additional credits by selecting one course from the School of Architecture, another offered by Engineering Innovation and Engineering Leadership Institutes, and one last course from the Rinker School of Construction Management. Listed below are candidate course elective under each unit.

From the Rinker School of Construction Management select one course:

- BCN 4753 Construction Finance
- BCN 4723 Design-Build Delivery Methods
- BCN 4252 Introduction to BIM
- BCN 4709 Project management

- BCN 4787 Construction Capstone (IPD has a separate section)
- BCN 3027 Intro to Construction Management (covers basic project management, human factors, introduces estimating and scheduling)
- BCN 3611 Estimating 1
- BCN 4720 Const. Planning and Control (scheduling)

From the HWCOE Engineering Innovation and Engineering Leadership Institutes:

- ESI 4XXX Engineering Project Management
- EGS 4038 Engineering Leadership
- EGN 4641 Engineering Entrepreneurship
- EGN 4643 Engineering Innovation

From the School of Architecture:

- ARC 4684 LEED for Sustainable Architecture
- ARC 4930 Coastal Construction
- ARC 4511 Structural Modeling
- ARC 4930 Advanced Architecture Connections
- ARC 4930 European Sustainability

In addition to managing the certificate program, the three Professors of Practice would develop shared extracurricular activities involving students and faculty from ESSIE and the Schools of Architecture and Construction Management and would develop shared capstone design projects for students in the three units. Lastly, they would convene a task force to look at additional opportunities for collaboration including continuing education and joint masters programs.

	HWCOE	M. E. Rinker, Sr. School of Construction Management	School of Architecture	Private Support
Faculty Salaries With Fringe	\$94,000	\$94,000	\$94,000	
Endowed Faculty Support (Fellowships)				\$1,500,000
Space	Weil 460 (2000 sq. ft.)			
Equipment and Renovation Costs for Weil 460	2000 sf			\$500,000
Equipment and Renovation Costs for Rinker/DCP	2000 sf	<u>2000 sf</u>		\$500,000

Formatted Table

⬇ BEN HILL GRIFFIN STADIUM ⬆

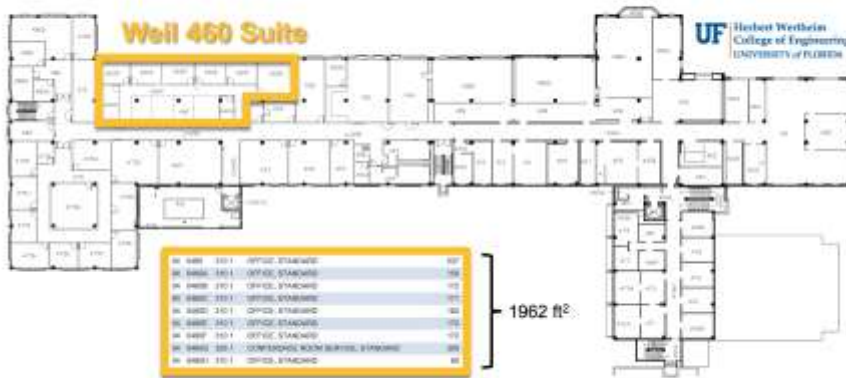

UF Herbert Wertheim
College of Engineering
UNIVERSITY OF FLORIDA

⬆ J. WAYNE REITZ UNION ⬇